

# HSF

## NOTES:

- Insulator material: PA9T+33%G.F, UL94 V-0;
- Terminal material: Copper Alloy;  
Terminal Plating: Au/Sn Plated Over Nickel ;
- Rated Voltage: 50V;
- Rated Current: Power 30A; Signal 2.5A;
- Contact Resistance:  
Power 0.7mΩ Max; Signal 20mΩ Max;
- Insulation Resistance: DC 500V  
Power 10000MΩ Min; Signal 500MΩ Min;
- Insulation Withstand Voltage:  
Power 2500VAC/1min; Signal 1000V AC/1min ;
- Durability :200 cycling;
- Operation Temperature: -20°C to +105°C;

P2MRA - XXX - XX XX XX X X A X

No. Right Power:  
01=1Pin  
20=20Pin

Tail Options (DIP Type):  
A=3.43mm  
B=2.29mm  
C=4.19mm

Fixed Mode:  
M: W/T Lock  
N: W/O Lock

Packing:  
A=Tray

1=W/O WCON  
2=W/T WCON

No. Signal:  
004=4Pin  
008=8Pin  
100=100Pin  
104=104Pin  
144=144Pin  
148=148Pin

Power Contact Plated:  
S3=10u" Gold /Tin  
S4=15u" Gold /Tin  
S5=30u" Gold /Tin

Signal Contact Plated:  
S3=10u" Gold /Tin  
S4=15u" Gold /Tin  
S5=30u" Gold /Tin

w3=10u" Gold /Matte Tin  
w4=15u" Gold /Matte Tin  
w5=30u" Gold /Matte Tin

w3=10u" Gold /Matte Tin  
w4=15u" Gold /Matte Tin  
w5=30u" Gold /Matte Tin

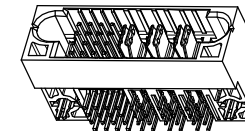
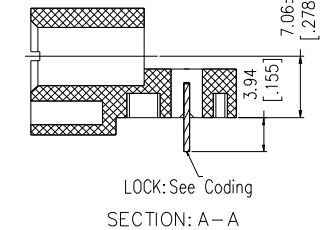
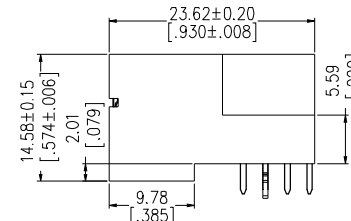
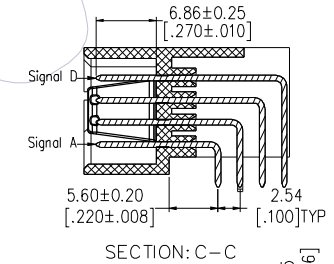
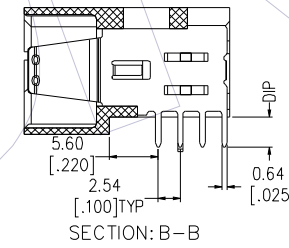
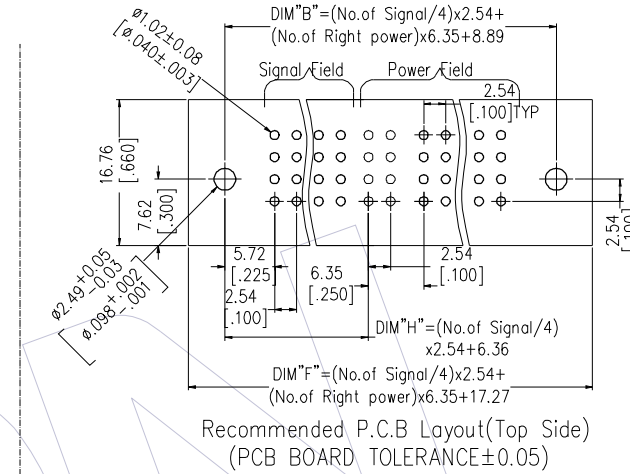
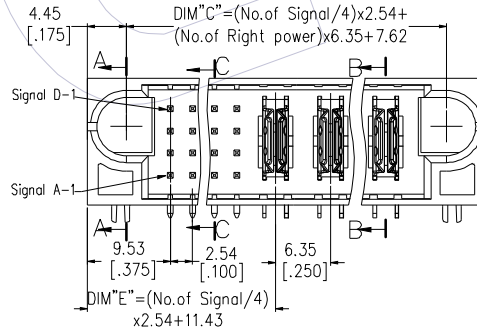
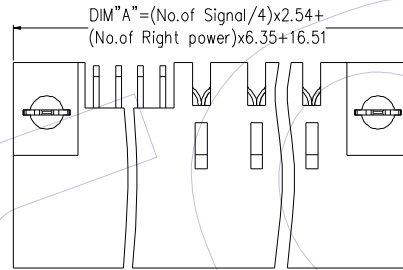
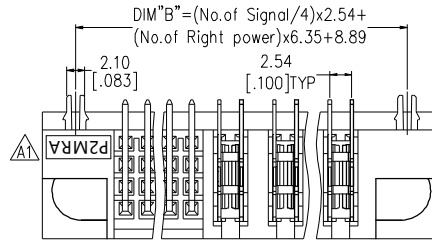
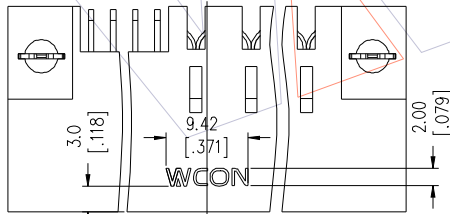

REV	DATE	MODIFICATION DESCRIPTION	CHANGE	OPERATION		DRAW XSR	DATE	SCALE	FIT	PART NO.
				x.x	±0.40					
A1	2021/07/27	Add W/T WCON Spec.&P/N;Correct Drawing	XSR	x.xx	±0.25	CHECK	2021/07/27	UNIT	mm	P2MRA-XXX-XXXXXXXXAX
A0	2018/10/10	NEW		x.xxx	±0.15	APPROVE		SIZE	A4	
				Angle	± 3°			SHEET	1/2	TITLE: PSP Spacing A 90° DIP MALE (TYPE-2: 2.54Signal+Right Power)
				DIM	TOL			PROJ.		Customer NO.

**WCON**  
Http: www.wcon.com

WCON-Dongguan  
Tel: +86 769 85358920  
Fax: +86 769 85358915  
E-mail: sales@wcon.com

WCON-Kunshan  
Tel: +86 512 57468408  
Fax: +86 512 57468468  
E-mail: salesks@wcon.com

No.	P/N	No. Signal	No. Right Power	DIM "A"	DIM "B"	DIM "C"	DIM "E"	DIM "F"	DIM "H"
1	P2MRA-072-05XXXXXXAX	72	5	93.98	86.36	85.09	57.15	94.74	52.07
2	P2MRA-064-03XXXXXXAX	64	3	76.2	68.58	67.31	52.07	76.96	46.99
3	P2MRA-064-02XXXXXXAX	64	2	69.85	62.23	60.96	52.07	70.61	46.99
4	P2MRA-056-11XXXXXXAX	56	11	121.92	114.30	113.03	46.99	122.68	41.91
5	P2MRA-048-12XXXXXXAX	48	12	123.19	115.57	114.30	41.91	123.95	36.83
6	P2MRA-048-08XXXXXXAX	48	8	97.79	90.17	88.90	41.91	98.55	36.83
7	P2MRA-048-07XXXXXXAX	48	7	91.44	83.82	82.55	41.91	92.20	36.83
8	P2MRA-048-03XXXXXXAX	48	3	66.04	58.42	57.15	41.91	66.80	36.83
9	P2MRA-048-02XXXXXXAX	48	2	59.69	52.07	50.80	41.91	60.45	36.83
10	P2MRA-040-07XXXXXXAX	40	7	86.36	78.74	77.47	36.83	87.12	31.75
11	P2MRA-040-06XXXXXXAX	40	6	80.01	72.39	71.12	36.83	80.77	31.75
12	P2MRA-036-06XXXXXXAX	36	6	77.47	69.85	68.58	34.29	78.23	29.21
13	P2MRA-036-05XXXXXXAX	36	5	71.12	63.50	62.23	34.29	71.88	29.21
14	P2MRA-036-03XXXXXXAX	36	3	58.42	50.80	49.53	34.29	59.18	29.21
15	P2MRA-032-18XXXXXXAX	32	18	151.13	143.51	142.24	31.75	151.89	26.67
16	P2MRA-032-08XXXXXXAX	32	8	87.63	80.01	78.74	31.75	88.39	26.67
17	P2MRA-032-06XXXXXXAX	32	6	74.93	67.31	66.04	31.75	75.69	26.67
18	P2MRA-032-04XXXXXXAX	32	4	62.23	54.61	53.34	31.75	62.99	26.67
19	P2MRA-032-02XXXXXXAX	32	2	49.53	41.91	40.64	31.75	50.29	26.67
20	P2MRA-028-08XXXXXXAX	28	8	85.09	77.47	76.20	29.21	85.85	24.13
21	P2MRA-028-06XXXXXXAX	28	6	72.39	64.77	63.50	29.21	73.15	24.13
22	P2MRA-024-20XXXXXXAX	24	20	158.75	151.13	149.86	26.67	159.51	21.59
23	P2MRA-024-16XXXXXXAX	24	16	133.35	125.73	124.46	26.67	134.11	21.59
24	P2MRA-024-14XXXXXXAX	24	14	120.65	113.03	111.76	26.67	121.41	21.59
25	P2MRA-024-12XXXXXXAX	24	12	107.95	100.33	99.06	26.67	108.71	21.59
26	P2MRA-024-10XXXXXXAX	24	10	95.25	87.63	86.36	26.67	96.01	21.59
27	P2MRA-024-08XXXXXXAX	24	8	82.55	74.93	73.66	26.67	83.31	21.59

No.	P/N	No. Signal	No. Right Power	DIM "A"	DIM "B"	DIM "C"	DIM "E"	DIM "F"	DIM "H"
28	P2MRA-024-07XXXXXXA1	24	7	76.20	68.58	67.31	26.67	76.96	21.59
29	P2MRA-024-06XXXXXXA1	24	6	69.85	62.23	60.96	26.67	70.61	21.59
30	P2MRA-024-04XXXXXXA1	24	4	57.15	49.53	48.26	26.67	57.91	21.59
31	P2MRA-024-03XXXXXXA1	24	3	50.80	43.18	41.91	26.67	51.56	21.59
32	P2MRA-020-06XXXXXXA1	20	6	67.31	59.69	58.42	24.13	68.07	19.05
33	P2MRA-020-05XXXXXXA1	20	5	60.96	53.34	52.07	24.13	61.72	19.05
34	P2MRA-020-04XXXXXXA1	20	4	54.61	46.99	45.72	24.13	55.37	19.05
35	P2MRA-016-12XXXXXXA1	16	12	102.87	95.25	93.98	21.59	103.63	16.51
36	P2MRA-016-08XXXXXXA1	16	8	77.47	69.85	68.58	21.59	78.23	16.51
37	P2MRA-016-06XXXXXXA1	16	6	64.77	57.15	55.88	21.59	65.53	16.51
38	P2MRA-016-05XXXXXXA1	16	5	58.42	50.80	49.53	21.59	59.18	16.51
39	P2MRA-016-04XXXXXXA1	16	4	52.07	44.45	43.18	21.59	52.83	16.51
40	P2MRA-016-02XXXXXXA1	16	2	39.37	31.75	30.48	21.59	40.13	16.51
41	P2MRA-012-18XXXXXXA1	12	18	138.43	130.81	129.54	19.05	139.19	13.97
42	P2MRA-012-13XXXXXXA1	12	13	106.68	99.06	97.79	19.05	107.44	13.97
43	P2MRA-012-10XXXXXXA1	12	10	87.63	80.01	78.74	19.05	88.39	13.97
44	P2MRA-012-08XXXXXXA1	12	8	74.93	67.31	66.04	19.05	75.69	13.97
45	P2MRA-012-06XXXXXXA1	12	6	62.23	54.61	53.34	19.05	62.99	13.97
46	P2MRA-012-05XXXXXXA1	12	5	55.88	48.26	46.99	19.05	56.64	13.97
47	P2MRA-012-04XXXXXXA1	12	4	49.53	41.91	40.64	19.05	50.29	13.97
48	P2MRA-012-02XXXXXXA1	12	2	36.83	29.21	27.94	19.05	37.59	13.97
49	P2MRA-008-12XXXXXXA1	8	12	97.79	90.17	88.90	16.51	98.55	11.43
50	P2MRA-008-10XXXXXXA1	8	10	85.09	77.47	76.20	16.51	85.85	11.43
51	P2MRA-008-07XXXXXXA1	8	7	66.04	58.42	57.15	16.51	66.80	11.43
52	P2MRA-008-06XXXXXXA1	8	6	59.69	52.07	50.80	16.51	60.45	11.43
53	P2MRA-008-04XXXXXXA1	8	4	46.99	39.37	38.10	16.51	47.75	11.43
54	P2MRA-008-02XXXXXXA1	8	2	34.29	26.67	25.40	16.51	35.05	11.43
55	P2MRA-004-06XXXXXXA1	4	6	57.15	49.53	48.26	13.97	57.91	8.89
56	P2MRA-004-04XXXXXXA1	4	4	44.45	36.83	35.56	13.97	45.21	8.89

				OPERATION	DRAW	DATE	SCALE	FIT	PART NO.	 <a href="http://www.wcon.com">Http: www.wcon.com</a>
				x.x	±0.40	XSR	2021/07/27	mm	P2MRA-XXX-XXXXXXAX 	
A1	2021/07/27	Add W/T WCON Spec.&P/N; Correct Drawing	XSR	x.xx	±0.25	CHECK	DATE	inch	TITLE:	
A0	2018/10/10	NEW	---	x.xxx	±0.15	APPROVE	DATE	A4	PSP Spacing A 90° DIP MALE (TYPE-2: 2.54Signal+Right Power)	
REV	DATE	MODIFICATION DESCRIPTION	CHANGE	Angle	± 3°			2/2	Customer NO.	WCON-Dongguan Tel: +86 769 85358920 Fax: +86 769 85358915 E-mail: sales@wcon.com
				DIM	TOL					WCON-Kunshan Tel: +86 512 57468408 Fax: +86 512 57468468 E-mail: salesks@wcon.com