

HSF

Recommended P.C.B Layout (Top Side)
(PCB BOARD TOLERANCE ±0.05)

NOTES:
Rated Current: 2.0AMP.
Contact Resistance: 20mΩ Max.
Withstand Voltage: 500V AC/DC
Insulation Resistance: 1000MΩ Min.
Operation Temperature: -40°C to +105°C

Contact Material: Brass
Contact Plating: Au or Sn Over Ni
Insulator Material: PA9T+33%G.F UL94V-0 BK

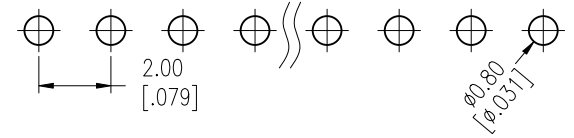
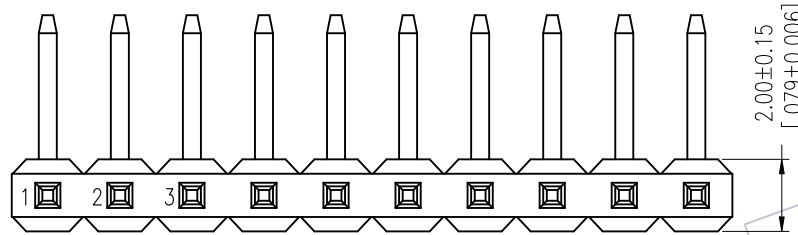

Ordering Information

1220-11 XX XX R XXX C 0 XX

No. of Pins	Contact Plating	Pin Length	Insulator	Packing	Series No.
02~40	G0=Gold Flash	L=A+B+D+3.0	Material	0=PE Bag	01~99
	G3=10u"Gold	Standard: 105=10.5	C=PA9T	T=Tube	
	G4=15u"Gold				
	G5=30u"Gold				
	S0=Gold Flash/Tin				
	S3=10u"Gold/Tin				
	S4=15u"Gold/Tin				
	S5=30u"Gold/Tin				
	SN=Tin				
	SM=Matte Tin				

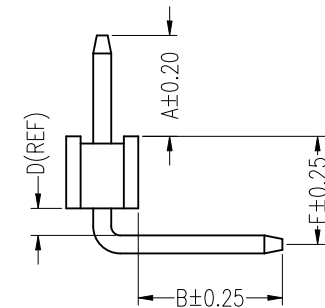
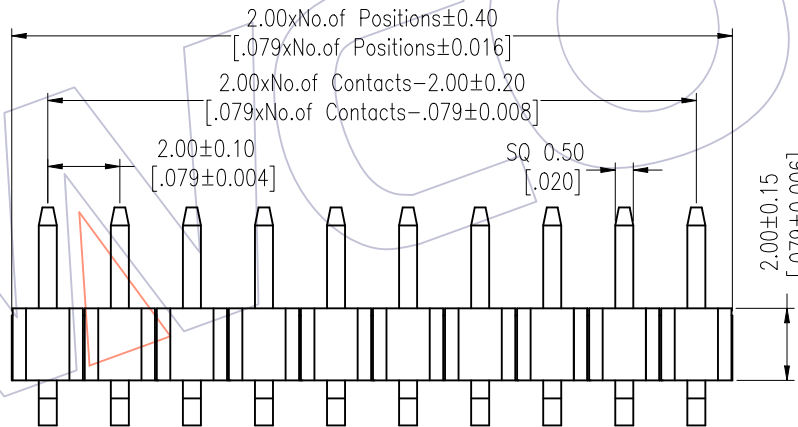

Item	Pin Length	A	B	E	Mating
Standard	10.50	2.80	4.00	3.00	2240 2243 2263 2272
Alternate					

OPERATION	DRAW	DATE	SCALE	Fit	PART NO.
X.X ± 0.40	<i>Liu</i>	2018.01.18	UNIT mm		1220-11XXXXRXXXCOXX
X.XX ± 0.25	CHECK	DATE	SIZE A4		TITLE: PH2.00 SINGLE ROW 90° PLANE BENDING H=2.0
X.XXX ± 0.15	APPROVE	DATE	SHEET 1/1		Customer NO.
Angle ± 3°			PROJ.		
DIM TOL					

WCON
Http: www.wcon.com

WCON-Dongguan WCON-Kunshan
Tel: +86 769 85358920 Tel: +86 512 57468408
Fax: +86 769 85358915 Fax: +86 512 57468468
E-mail: sales@wcon.com E-mail: salesks@wcon.com