

# HSF

## NOTES:

- 1.Current Rating: 3.2A per pin;
- 2.Contact Resistance: 20mΩ Max;
- 3.Withstand Voltage: 500V AC/DC;
- 4.Insulation Resistance: 1000MΩ Min at 500V DC;
- 5.Operating Temperature: -55°C to +125°C;
- 6.Insulator(Housing&Cover) Material: LCP,G.F,UL94V-0,BK;
- 7.Contact Material: Copper Alloy;
- 8.Contact plating:  
xxμ" Gold on contact area  
(See ordering information),  
100μ" Matte TIN on solder area,  
50μ" Nickel underplating overall;
- 9.Recommended process:  
Wave soldering,  
Peak temperature: 260±5°C, 5s ;

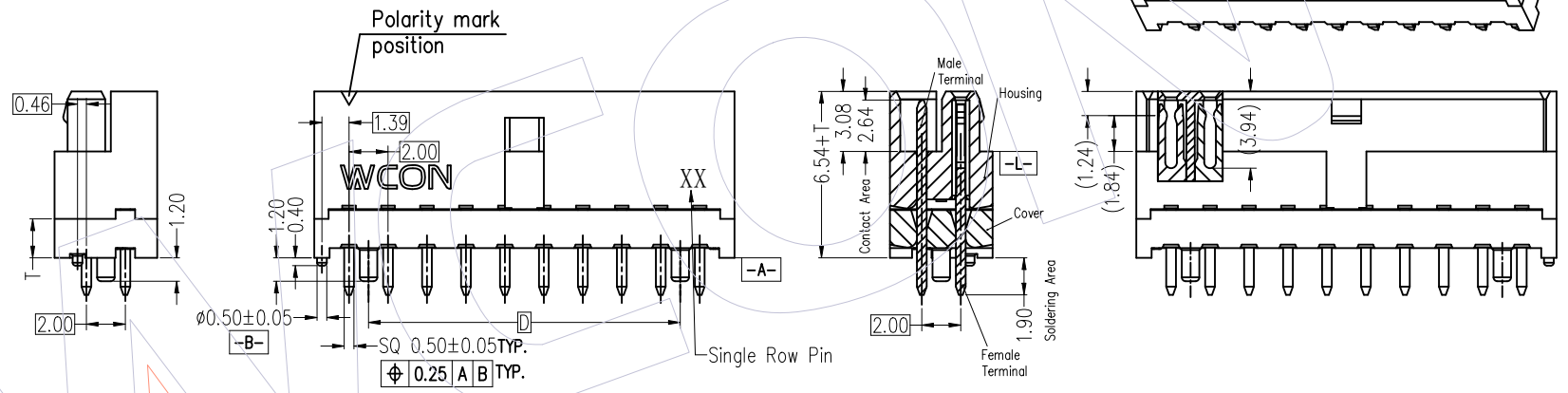
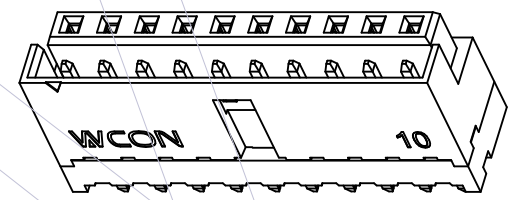
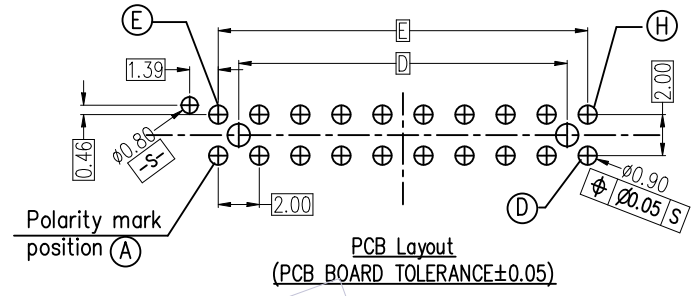
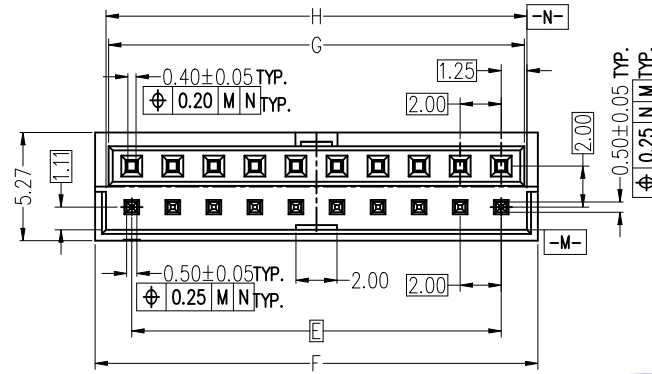

T
1.50
2.00
3.00
5.00

## Ordering Information

3703 - A XXX - XXX S XX X 01

- TYPE COMBO Pulg/Socket
- No. of Positions: 005:5PIN, 010:10PIN (SP-30P)
- Insulator Height: 065:6.54mm
- Contact Shape: M:SMT, S:180 DIP, R:90 DIP
- Internal Code: 01:With post, 02:Without post
- Packing: T:Tube, R:Tape&Reel
- Contact Plating: W0=Gold Flash/Matte Tin, W3=10u" Gold/Matte Tin, W5=30u" Gold/Matte Tin

Pin Dim	D	E	F	G	H
2*05	6.00	8.00	11.57 <sup>+0.20</sup> <sub>-0.20</sub>	10.25 <sup>+0.08</sup> <sub>-0.20</sub>	10.51 <sup>+0.20</sup> <sub>-0.08</sub>
2*06	8.00	10.00	13.57 <sup>+0.20</sup> <sub>-0.20</sub>	12.25 <sup>+0.08</sup> <sub>-0.25</sub>	12.51 <sup>+0.25</sup> <sub>-0.08</sub>
2*08	12.00	14.00	17.57 <sup>+0.25</sup> <sub>-0.25</sub>	16.25 <sup>+0.08</sup> <sub>-0.25</sub>	16.51 <sup>+0.25</sup> <sub>-0.08</sub>
2*10	16.00	18.00	21.57 <sup>+0.25</sup> <sub>-0.25</sub>	20.25 <sup>+0.10</sup> <sub>-0.30</sub>	20.51 <sup>+0.30</sup> <sub>-0.10</sub>
2*13	22.00	24.00	27.57 <sup>+0.25</sup> <sub>-0.25</sub>	26.25 <sup>+0.10</sup> <sub>-0.30</sub>	26.51 <sup>+0.30</sup> <sub>-0.10</sub>
2*15	26.00	28.00	31.57 <sup>+0.30</sup> <sub>-0.30</sub>	30.25 <sup>+0.10</sup> <sub>-0.30</sub>	30.51 <sup>+0.30</sup> <sub>-0.10</sub>
2*20	36.00	38.00	41.57 <sup>+0.30</sup> <sub>-0.30</sub>	40.25 <sup>+0.10</sup> <sub>-0.30</sub>	40.51 <sup>+0.30</sup> <sub>-0.10</sub>
2*30	56.00	58.00	61.57 <sup>+0.30</sup> <sub>-0.30</sub>	60.25 <sup>+0.10</sup> <sub>-0.30</sub>	60.51 <sup>+0.30</sup> <sub>-0.10</sub>

OPERATION	DRAW	DATE	SCALE	FIT	PART NO.
x.x ±0.40	Kair	2021/08/21	UNIT	mm	3703-AXXX-XXXSXXX01
x.xx ±0.25	CHECK	DATE	SIZE	A4	TITLE:
x.xxx ±0.15	APPROVE	DATE	SHEET	1/3	2.00mm 公母合体连接器
Angle ± 3°			PROJ.	Customer NO.	180度DIP TYPE
DIM TOL					



Http: [www.wcon.com](http://www.wcon.com)

WCON-Dongguan      WCON-Kunshan

Tel: +86 769 85358920      Tel: +86 512 57468408

Fax: +86 769 85358915      Fax: +86 512 57468468

E-mail: [sales@wcon.com](mailto:sales@wcon.com)      E-mail: [salesks@wcon.com](mailto:salesks@wcon.com)

# HSF

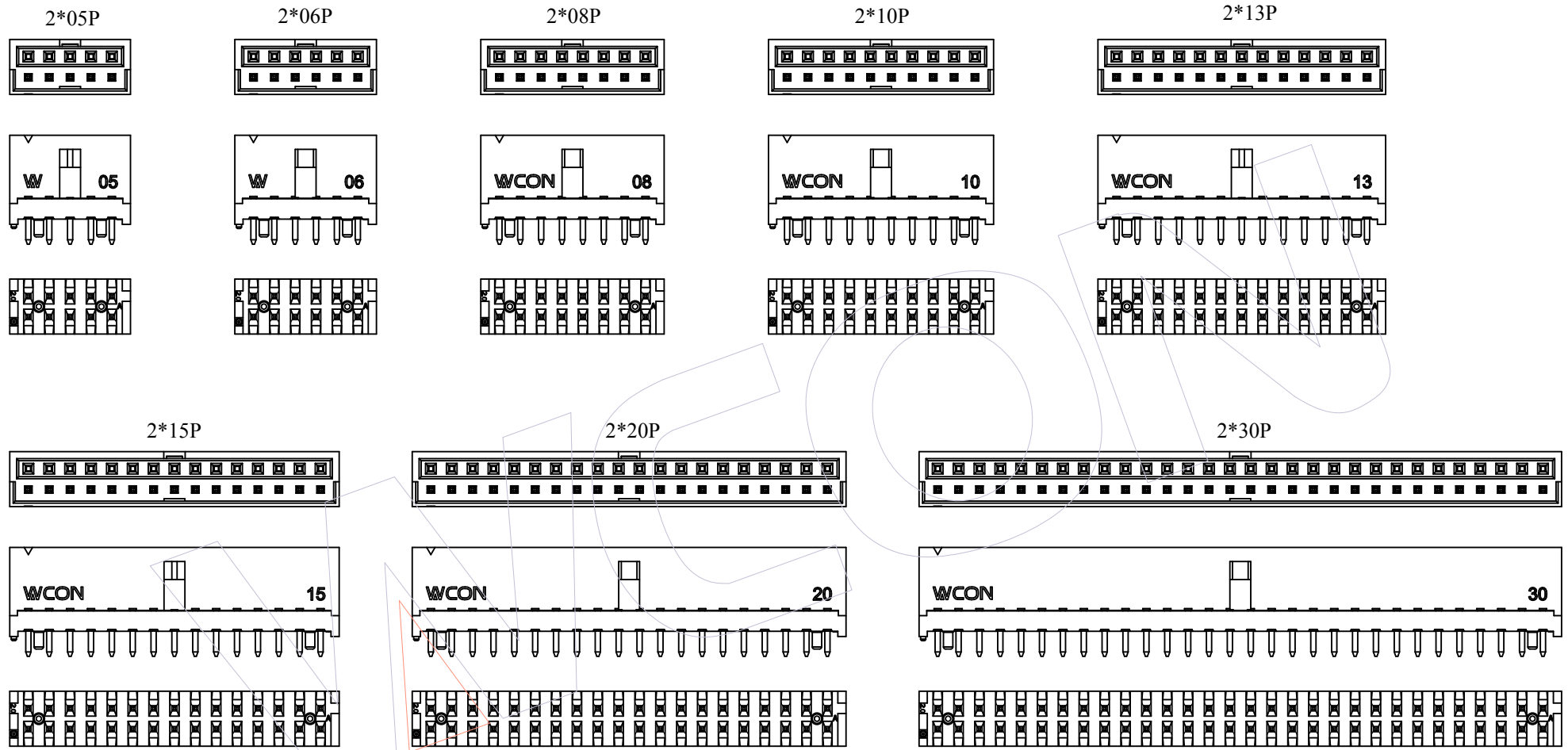

				OPERATION	DRAW	DATE	SCALE	FIT	PART NO.
				x.x ±0.40	Kair	2021/08/21	UNIT	mm	3703-AXXX-XXXSXXX01
				x.xx ±0.25	CHECK	DATE	SIZE	A4	TITLE:
				x.xxx ±0.15	APPROVE	DATE	SHEET	2/3	2.00mm 公母合体连接器 180度DIP TYPE
A0	2021/08/21	NEW	Kair	Angle ± 3°			PROJ.	⌀	Customer NO.
REV	DATE	MODIFICATION DESCRIPTION	CHANGE	DIM TOL					

**WCON**

Http: [www.wcon.com](http://www.wcon.com)

WCON-Dongguan	WCON-Kunshan
Tel: +86 769 85358920	Tel: +86 512 57468408
Fax: +86 769 85358915	Fax: +86 512 57468468
E-mail: <a href="mailto:sales@wcon.com">sales@wcon.com</a>	E-mail: <a href="mailto:salesks@wcon.com">salesks@wcon.com</a>

# HSF

## Application and assembly

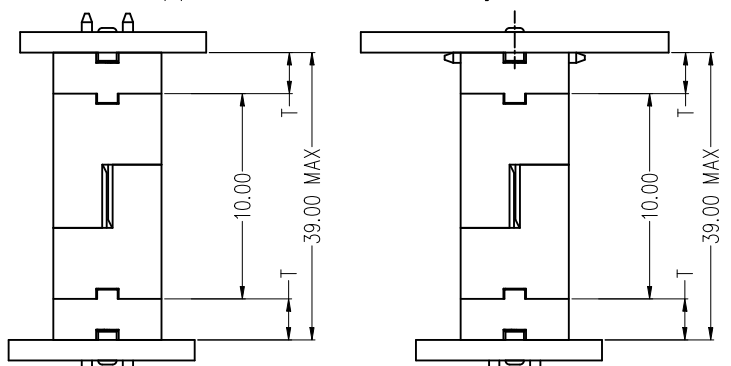

3703-AXXX-XXSX01  
3703-AXXX-XXSX01

3703-AXXX-XXSXXX01  
3703-AXXX-XXMXXX01

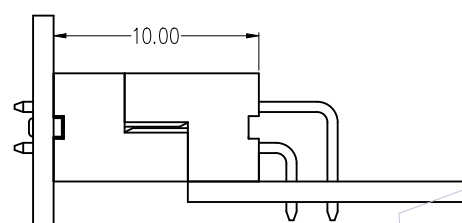

3703-AXXX-065SXXX01  
3703-AXXX-065RXXX01

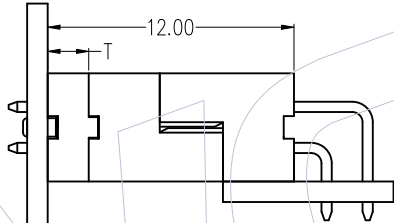

3703-AXXX-XXSXXX01  
3703-AXXX-065RXXX01

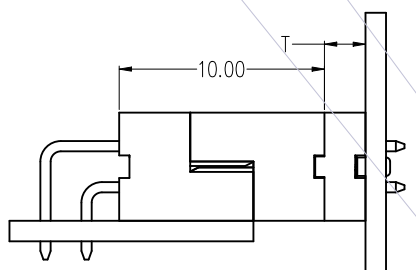

3703-AXXX-XXSXXX01  
3703-AXXX-065RXXX02

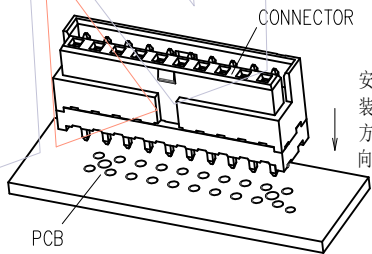

ALLOWED ANGULAR TRANSVERSE



ALLOWED ANGULAR LONGITUDINAL

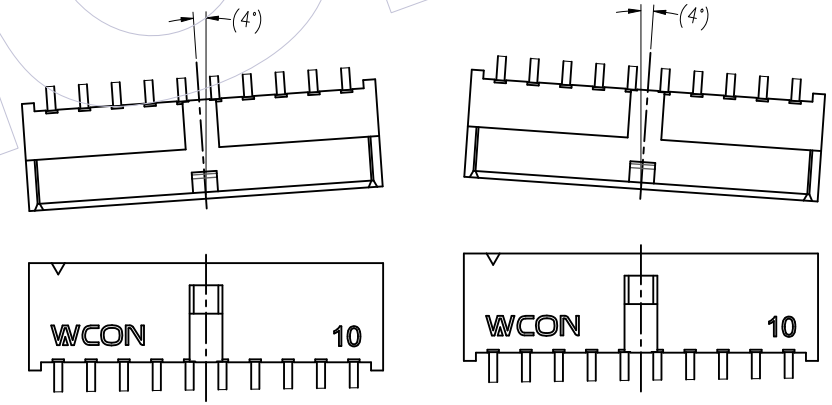

				OPERATION	DRAW	DATE	SCALE	FIT	PART NO.
				x.x ±0.40	Kair	2021/08/21	UNIT	mm	3703-AXXX-XXSXXX01
				x.xx ±0.25	CHECK	DATE	SIZE	inch	TITLE:
				x.xxx ±0.15			SHEET	A4	2.00mm 公母合体连接器
A0	2021/08/21	NEW	Kair	Angle ± 3°	APPROVE	DATE	PROJ.	3/3	180度DIP TYPE
REV	DATE	MODIFICATION DESCRIPTION	CHANGE	DIM TOL					Customer NO.

# WCON

Http: [www.wcon.com](http://www.wcon.com)

WCON-Dongguan  
Tel: +86 769 85358920  
Fax: +86 769 85358915  
E-mail: [sales@wcon.com](mailto:sales@wcon.com)

WCON-Kunshan  
Tel: +86 512 57468408  
Fax: +86 512 57468468  
E-mail: [salesks@wcon.com](mailto:salesks@wcon.com)