

# HSF

**NOTES:**

Rated Current: 3.0AMP.(20°C, 1\*2P-1\*15P)  
 2.0AMP.(20°C, 1\*16P-1\*40P)  $\triangle A4$   
 Contact Resistance: 20mΩ Max.  
 Withstand Voltage: 500V AC/DC  
 Insulation Resistance: 1000MΩ Min.  
 Operation Temperature: -40°C to +125°C(Gold Plating)  $\triangle A2$   $\triangle A4$   
 -40°C to +105°C(Tin Plating)  $\triangle A2$   $\triangle A4$   
 Contact Material: Copper Alloy  
 Contact Plating: Au or Sn Over 30u" Min Ni  $\triangle A4$   
 Insulator Material: PA9T+G.F UL94V-0 BK  $\triangle A4$

## Ordering Information

1215- 1 1 XX XX R XXX C 0 XX

Plastic Layer  
 Plastic Row  
 No. of Pins Per Row: 02-40  $\triangle A3$   
 Contact Plating  
 G0=Gold Flash  
 G3=10u"Au, BG3=8u"PdNi+2u"Au  
 G4=15u"Au, BG4=13u"PdNi+2u"Au  
 G5=30u"Au, BG5=28u"PdNi+2u"Au  
 S0=Gold Flash/Tin  
 S3=10u"Au/Sn, P3=8u"PdNi+2u"Au/Sn  
 S4=15u"Au/Sn, P4=13u"PdNi+2u"Au/Sn  
 S5=30u"Au/Sn, P5=28u"PdNi+2u"Au/Sn  
 SN=Bright Tin  $\triangle A4$   
 SM=Matte Tin

Series No. 01-99  
 Packing 0=PE Bag  
 Insulator Material C=PA9T  
 Pin Length L(See Table)  
 Type: R/R/A

Item	Pin Length	A	D	E	B	Mating
Standard	8.5	2.8	0.75	2.5	2.5	2220T/2221/2228
	9.0				3.0	2227T/2228T/2245
	9.5				3.5	2235/2240N/2243C
	10.0				4.0	2240/2243/2245T/2263/2272
Standard	7.5	2.0 (THR)	0.75	2.5	2.5	2220T/2221/2228
	8.0				3.0	2227T/2228T/2245
	8.5				3.5	2235/2240N/2243C
	9.0				4.0	2240/2243/2245T/2263/2272
Alternate						

Recommended P.C.B Layout (Top Side)  
 (PCB BOARD TOLERANCE ±0.05)  
 (PCB Thickness: T=1.60mm)

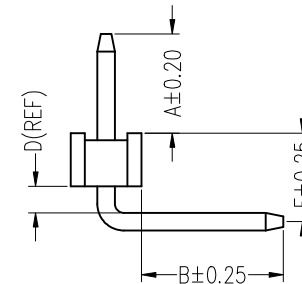
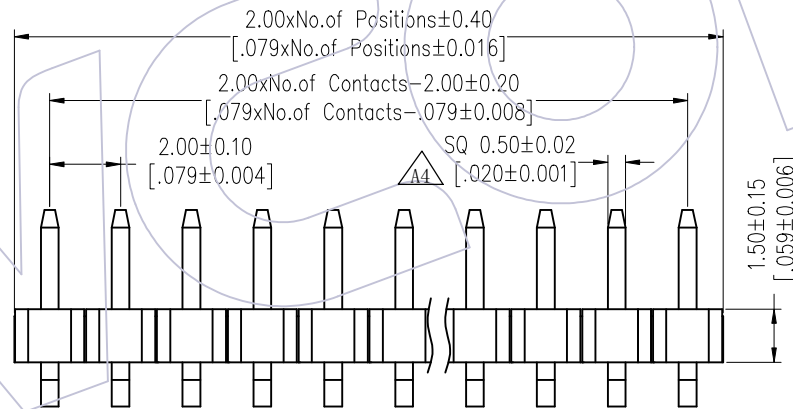
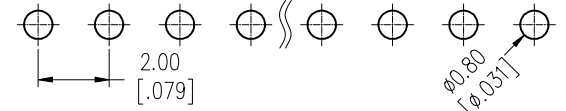
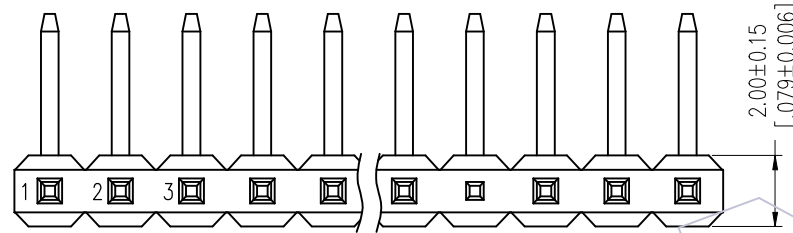

REV	DATE	MODIFICATION DESCRIPTION	CHANGE	OPERATION	DRAW	DATE	SCALE	Fit	PART NO.
A4	2025/04/03	Standardization Drawing	CP	OPERATION	DRAW	2025/04/03	SCALE	Fit	PART NO. 1215-11XXXXRXXXCOXX $\triangle A1$
A3	2020/06/15	Modify Pin 02~40P	Du Ying	x.X ±0.40	CP	2025/04/03	UNIT	mm	TITLE: PH2.00 SINGLE ROW 90° H=1.5 PLANE BENDING
A2	2019/02/28	Modify	Ding	x.XX ±0.25	CHECK TANG	2025/04/03	SIZE	A4	
A0	2012/04/18	NEW	William Chen	x.XXX ±0.15	APPROVE Steven Zhao	2025/04/03	SHEET	1/2	Customer NO.
				Angle ± 3°			PROJ.		
				DIM TOL					



Http: [www.wcon.com](http://www.wcon.com)

WCON-Dongguan Tel: +86 769 85358920 Fax: +86 769 85358915 E-mail: <a href="mailto:sales@wcon.com">sales@wcon.com</a>	WCON-Kunshan Tel: +86 512 57468408 Fax: +86 512 57468468 E-mail: <a href="mailto:salesks@wcon.com">salesks@wcon.com</a>
-------------------------------------------------------------------------------------------------------------------------------	----------------------------------------------------------------------------------------------------------------------------------

HSF

Packing:

Packaging Quantity Refers To The Following Table

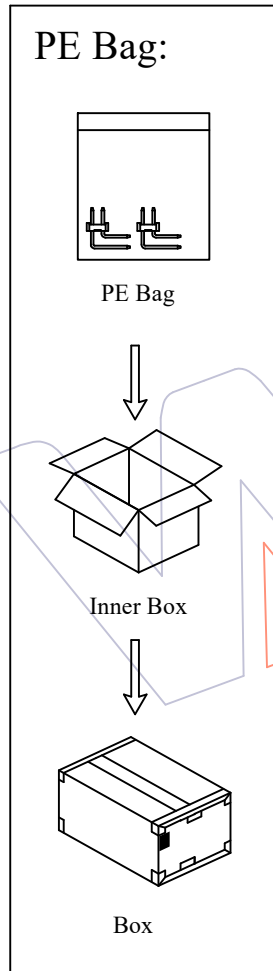

PINS /Row	Q'ty/Bag (L≤11.0)	PINS /Row	Q'ty/Bag (L≤11.0)
1	1000	21	100
2	1000	22	100
3	1000	23	100
4	500	24	100
5	500	25	100
6	500	26	100
7	500	27	100
8	500	28	100
9	500	29	100
10	300	30	100
11	300	31	50
12	200	32	50
13	300	33	50
14	300	34	50
15	300	35	50
16	200	36	50
17	200	37	50
18	200	38	50
19	200	39	50
20	200	40	50

A5	2025/07/24	Standardization Drawing	CP	OPERATION	DRAW	DATE	SCALE	Fit	PART NO.
A4	2023/09/21	Modify Plastic Appearance	Du Ying	x.X ±0.40	CP	2025/07/24	UNIT	mm	1215-12XXXXRXXXCOXX
A3	2020/06/11	Modify Pin 02~40P	Du Ying	x.XX ±0.25	CHECK	DATE	SIZE	A4	TITLE:
A0	2012/04/18	NEW	William Chen	x.XXX ±0.15	TANG	2025/07/24	SHEET	2/2	PH2.00 DUAL ROW 90° H=1.5 PLANE BENDING
REV	DATE	MODIFICATION DESCRIPTION	CHANGE	Angle ± 3°	APPROVE	DATE	PROJ.		Customer NO.
				DIM TOL	Steven Zhao	2025/07/24			

Http: [www.wcon.com](http://www.wcon.com)

WCON-Dongguan Tel: +86 769 85358920 Fax: +86 769 85358915 E-mail: <a href="mailto:sales@wcon.com">sales@wcon.com</a>	WCON-Kunshan Tel: +86 512 57468408 Fax: +86 512 57468468 E-mail: <a href="mailto:salesks@wcon.com">salesks@wcon.com</a>
-------------------------------------------------------------------------------------------------------------------------------	----------------------------------------------------------------------------------------------------------------------------------