

HSF

NOTES:

Rated Current:1.5AMP.(20°C,2*2P-2*15P)
 1.0AMP.(20°C,2*16P-2*50P) $\triangle A2$

Contact Resistance:20mΩ Max.

Withstand Voltage:500V AC/DC

Insulation Resistance:1000MΩ Min.

Operation Temperature:-40°C to +125°C(Gold Plating)
 -40°C to +105°C(Tin Plating) $\triangle A2$

Contact Material:Copper Alloy

Contact Plating:Au or Sn Over 30u" Min Ni

Insulator Material:PA9T+G.F UL94V-0 BK $\triangle A2$

Recommended P.C.B Layout (Top Side)
 (PCB BOARD TOLERANCE±0.05)
 (PCB Thickness:T=1.60m)

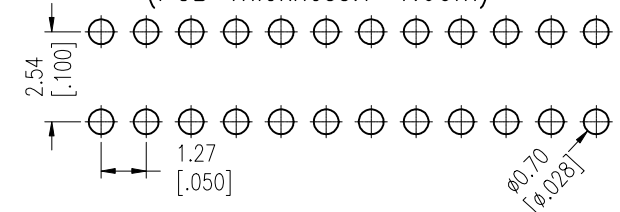
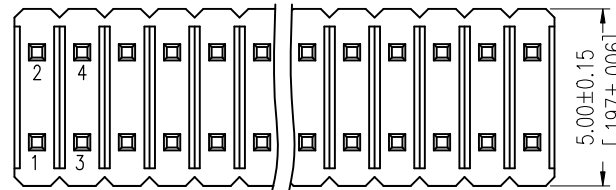

Ordering Information

1425-2 2 XX XX S XXX C A XX $\triangle A2$

Plastic Layer
 Plastic Row
 No. of Pins
 Per Row:02~50
 Contact Plating
 G0=Gold Flash
 G3=10u"Au, BG3=8u"PdNi+2u"Au
 G4=15u"Au, BG4=13u"PdNi+2u"Au
 G5=30u"Au, BG5=28u"PdNi+2u"Au
 S0=Gold Flash/Tin
 S3=10u"Au/Sn, P3=8u"PdNi+2u"Au/Sn
 S4=15u"Au/Sn, P4=13u"PdNi+2u"Au/Sn
 S5=30u"Au/Sn, P5=28u"PdNi+2u"Au/Sn
 SN=Bright Tin
 SM=Matte Tin

Series No.
 01~99
 Packing
 A=Tray
 Insulator Material
 C=PA9T(Standard)
 Pin Length
 L(See Table)
 Type:
 S=S/T

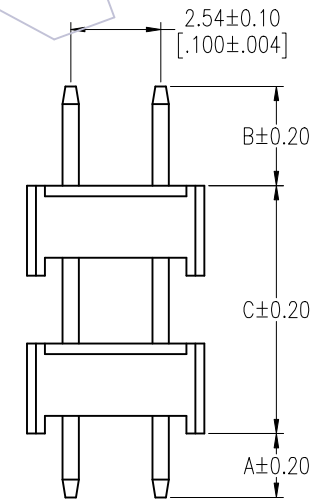
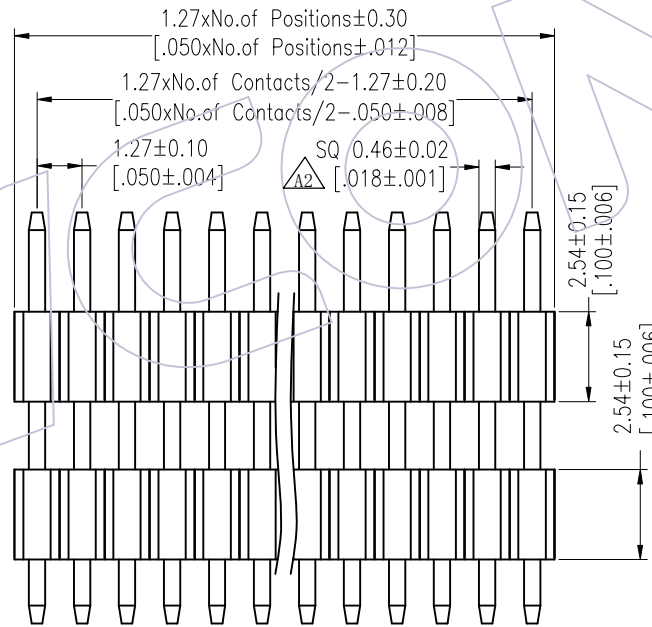

TYPE-1

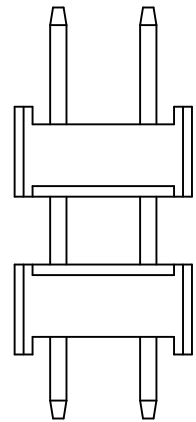

TYPE-2

REV	DATE	MODIFICATION DESCRIPTION	CHANGE	OPERATION	DRAW	DATE	SCALE	Fit	PART NO.
A2	2025/12/23	Standardization Drawing	CP	x.X ±0.40	CP	2025/12/23	UNIT	mm [inch]	1425-22XXXXXXCXXX $\triangle A2$
A1	2018/01/12	MODIFY PART NO.	William Chen	x.XX ±0.25	CHECK	2025/12/23	SIZE	A4	TITLE: 1.27*2.54 Pin Header, DUAL ROW, S/T, DOUBLE PLASTIC, H=2.54
AO	2012/04/06	NEW	William Chen	x.XXX ±0.15	TANG	2025/12/23	SHEET	1/3	Customer NO.
				Angle ± 3'	APPROVE	2025/12/23	PROJ.		
				DIM TOL	Steven Zhao				

WCON
 Http: www.wcon.com

WCON-Dongguan
 Tel: +86 769 85358920
 Fax: +86 769 85358915
 E-mail: sales@wcon.com

WCON-Kunshan
 Tel: +86 512 57468408
 Fax: +86 512 57468468
 E-mail: sales@wcon.com

HSF

Table 1

Item	Pin Length	A	C	B	Mating
Standard	10.0	3.00	5.1	2.0	2321/2320T
	11.0			3.0	2334/2344/2346
	11.6			3.5	2357
	12.5			4.5	2345/2385
	11.3		6.3	2.0	2321/2320T
	12.3			3.0	2334/2344/2346
	12.8			3.5	2357
	13.8			4.5	2345/2385
	15.5		10.5	2.0	2321/2320T
	16.5			3.0	2334/2344/2346
	17.0			3.5	2357
	18.0			4.5	2345/2385
	16.0		11.0	2.0	2321/2320T
	17.0			3.0	2334/2344/2346
	17.5			3.5	2357
	18.5			4.5	2345/2385
Alternate					

Item	Pin Length	A	C	B	Mating
Standard	9.0	2.0 (THR)	5.1	2.0	2321/2320T
	10.0			3.0	2334/2344/2346
	10.6			3.5	2357
	11.6			4.5	2345/2385
	10.3		6.3	2.0	2321/2320T
	11.3			3.0	2334/2344/2346
	11.8			3.5	2357
	12.8			4.5	2345/2385
	14.5		10.5	2.0	2321/2320T
	15.5			3.0	2334/2344/2346
	16.0			3.5	2357
	17.0			4.5	2345/2385
	15.0		11.0	2.0	2321/2320T
	16.0			3.0	2334/2344/2346
	16.5			3.5	2357
	17.5			4.5	2345/2385
Alternate					

Packing:

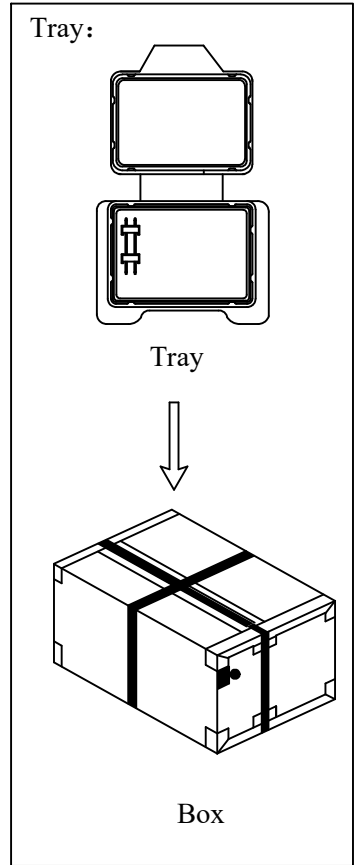

REV	DATE	MODIFICATION DESCRIPTION	CHANGE	OPERATION	DRAW	DATE	SCALE	Fit	PART NO.
A2	2025/12/23	Standardization Drawing	CP	x.X ±0.40	CP	2025/12/23	UNIT	mm [inch]	1425-22XXXXXXXCXXX Δ
A1	2018/01/12	MODIFY PART NO.	William Chen	x.xx ±0.25	CHECK	2025/12/23	SIZE	A4	TITLE:
AO	2012/04/06	NEW	William Chen	x.xxx ±0.15	TANG		SHEET	2/3	1.27*2.54 Pin Header, DUAL ROW, S/T, DOUBLE PLASTIC, H=2.54
				Angle ± 3'	APPROVE	DATE	PROJ.		Customer NO.
				DIM TOL	Steven Zhao	2025/12/23			

WCON
Http: www.wcon.com

WCON-Dongguan
Tel: +86 769 85358920
Fax: +86 769 85358915
E-mail: sales@wcon.com

WCON-Kunshan
Tel: +86 512 57468408
Fax: +86 512 57468468
E-mail: salesks@wcon.com

HSF

Packaging Quantity Refers To The Following Table

PINS /Row	Q' ty/Tray (9.0 ≤ L ≤ 12.8)	Q' ty/Box	PINS /Row	Q' ty/Tray (9.0 ≤ L ≤ 12.8)	Q' ty/Box	PINS /Row	Q' ty/Tray (12.8 < L ≤ 16.5)	Q' ty/Box	PINS /Row	Q' ty/Tray (12.8 < L ≤ 16.5)	Q' ty/Box	PINS /Row	Q' ty/Tray (16.5 < L ≤ 18.5)	Q' ty/Box	PINS /Row	Q' ty/Tray (16.5 < L ≤ 18.5)	Q' ty/Box
1	600	28,800	26	30	1,440	1	600	28,800	26	20	960	1	500	24,000	26	20	960
2	300	14,400	27	20	960	2	300	14,400	27	20	960	2	200	9,600	27	20	960
3	200	9,600	28	20	960	3	200	9,600	28	20	960	3	150	7,200	28	20	960
4	200	9,600	29	20	960	4	200	9,600	29	20	960	4	100	4,800	29	15	720
5	100	4,800	30	20	960	5	100	4,800	30	20	960	5	100	4,800	30	15	720
6	100	4,800	31	20	960	6	100	4,800	31	20	960	6	80	3,840	31	15	720
7	100	4,800	32	20	960	7	80	3,840	32	20	960	7	80	3,840	32	15	720
8	100	4,800	33	20	960	8	80	3,840	33	20	960	8	50	2,400	33	15	720
9	50	2,400	34	20	960	9	50	2,400	34	15	720	9	50	2,400	34	15	720
10	50	2,400	35	20	960	10	50	2,400	35	15	720	10	50	2,400	35	15	720
11	50	2,400	36	20	960	11	50	2,400	36	15	720	11	50	2,400	36	15	720
12	50	2,400	37	20	960	12	50	2,400	37	15	720	12	30	1,440	37	15	720
13	50	2,400	38	20	960	13	50	2,400	38	15	720	13	30	1,440	38	15	720
14	50	2,400	39	20	960	14	30	1,440	39	15	720	14	30	1,440	39	10	480
15	50	2,400	40	20	960	15	30	1,440	40	15	720	15	30	1,440	40	10	480
16	50	2,400	41	15	720	16	30	1,440	41	15	720	16	30	1,440	41	10	480
17	30	1,440	42	15	720	17	30	1,440	42	15	720	17	30	1,440	42	10	480
18	30	1,440	43	15	720	18	30	1,440	43	10	480	18	30	1,440	43	10	480
19	30	1,440	44	15	720	19	30	1,440	44	10	480	19	30	1,440	44	10	480
20	30	1,440	45	15	720	20	30	1,440	45	10	480	20	20	960	45	10	480
21	30	1,440	46	15	720	21	30	1,440	46	10	480	21	20	960	46	10	480
22	30	1,440	47	15	720	22	20	960	47	10	480	22	20	960	47	10	480
23	30	1,440	48	15	720	23	20	960	48	10	480	23	20	960	48	10	480
24	30	1,440	49	15	720	24	20	960	49	10	480	24	20	960	49	10	480
25	30	1,440	50	15	720	25	20	960	50	10	480	25	20	960	50	10	480

REV	DATE	MODIFICATION DESCRIPTION	CHANGE	OPERATION	DRAW	DATE	SCALE	Fit	PART NO.
A2	2025/12/23	Standardization Drawing	CP	x.X ±0.40	CP	2025/12/23	UNIT	mm [inch]	1425-22XXXXXXXCXXX Δ
A1	2018/01/12	MODIFY PART NO.	William Chen	x.XX ±0.25	CHECK	DATE	SIZE	A4	TITLE:
AO	2012/04/06	NEW	William Chen	x.XXX ±0.15	TANG	2025/12/23	SHEET	3/3	1.27*2.54 Pin Header, DUAL ROW, S/T, DOUBLE PLASTIC, H=2.54
				Angle ± 3'	APPROVE	DATE	PROJ.		Customer NO.
				DIM TOL	Steven Zhao	2025/12/23			



Http: www.wcon.com

WCON-Dongguan Tel: +86 769 85358920 Fax: +86 769 85358915 E-mail: sales@wcon.com	WCON-Kunshan Tel: +86 512 57468408 Fax: +86 512 57468468 E-mail: salesks@wcon.com
---	--